

Place SAM3426T1 profile block on side spindle 2.  
 Place SAM 3426T2 profile block on side spindle 3.  
 Place 4mm saw blade on side spindle 5, set to produce 4.00mm x15.00mm deep groove.  
 Place SAM 3427T1 profile block on the first top spindle.  
 Place SAM 3427T2 profile block on the second top spindle.

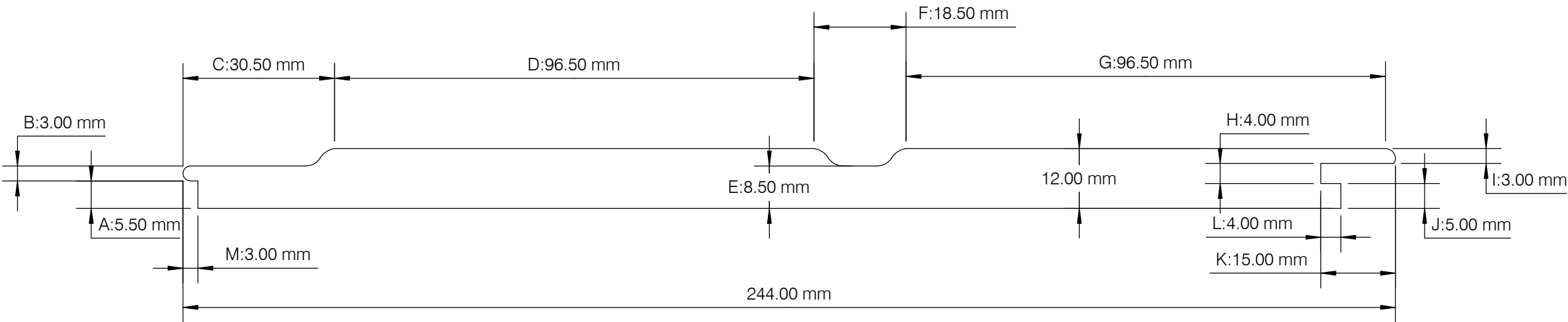

SAM TRIMAX  
 Double Square Shiplap Cladding

MOULDER	4
PASSES	1
DRAWN BY	Bart Sobecki
DATE	06/11/2024
SCALE	1:1
REV:	1
AUTH:	
TOLERANCE	+/- 0.5MM



Newpark Industrial Estate  
 Greystone Road, Antrim  
 BT41 2RU  
 T: +44 (0)28 9442 8288 F: +44 (0)28 9442 8244  
 E: team@samonline.co.uk  
 W: www.samonline.co.uk

PROFILE	SAM 5555
---------	----------