

Place SAM 04T1 profile block on side spindle 2, to produce 1.5 mm radius.
 Place SAM 04T2 profile block on side spindle 3, to produce 1.5 mm radius.
 Place groover to suit dim A on the first spindle, set to produce groove.

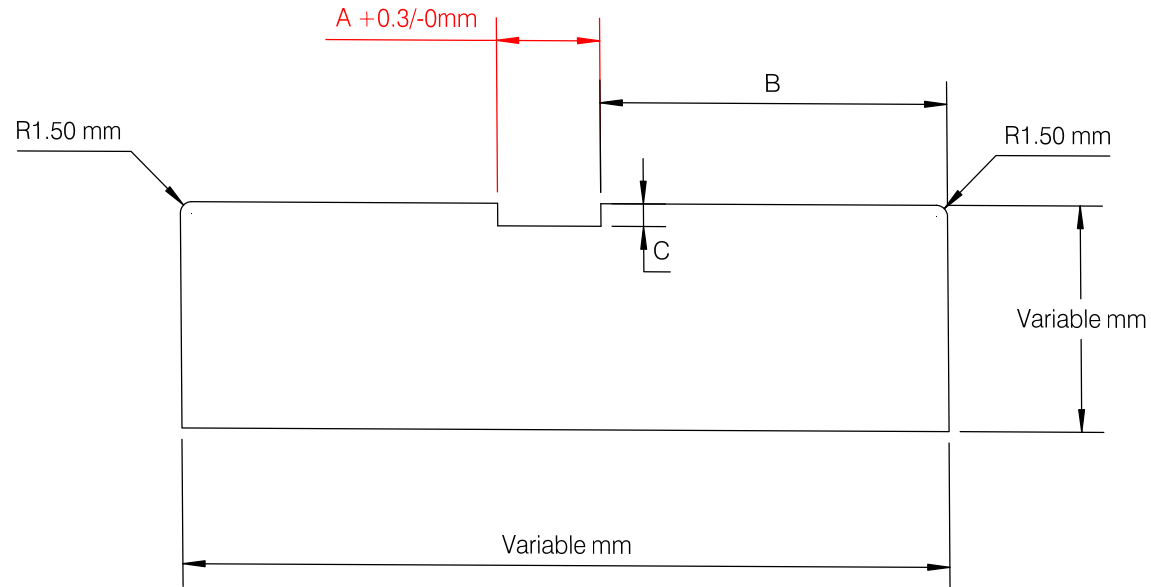

PLEASE NOTE: DIMENSION 'A' IS FOR INTUMESCENT STRIPS.
 PLEASE CHECK TO SEE IF THE GO/NO GO GAUGE FITS INTO GROOVE.
 10mm, 15mm AND 20mm GO/NO GO GAUGES ARE AVAILABLE IN THE TOOLROOM.

PRINTED COPY UNCONTROLLED

AREA MACHINED AWAY BY ROUNDS : 0.98 SQ MM

MOULDER	ANY
PASSES	1
DRAWN BY	S McMaster
DATE	18/06/2019
SCALE	1:1
REV:	1
AUTH:	
TOLERANCE	+/- 0.5MM



Newpark Industrial Estate
 Greystone Road, Antrim
 BT41 2RU
 T: +44 (0)28 9442 8288 F: +44 (0)28 9442 8244
 E: team@samonline.co.uk
 W: www.samonline.co.uk

PROFILE
 SP 730