

Place SP1447T1 profile block on side spindle 2.
 Place SP1447T2 profile block on side spindle 3.
 Place 8mm-15mm adjustable groover on side spindle 4, set at 8.5mm. Set to produce 8.50mm x 10.00mm groove.
 Place 8mm-15mm adjustable groover on side spindle 5, set at 8.5mm. Set to produce 8.50mm x 10.00mm groove.

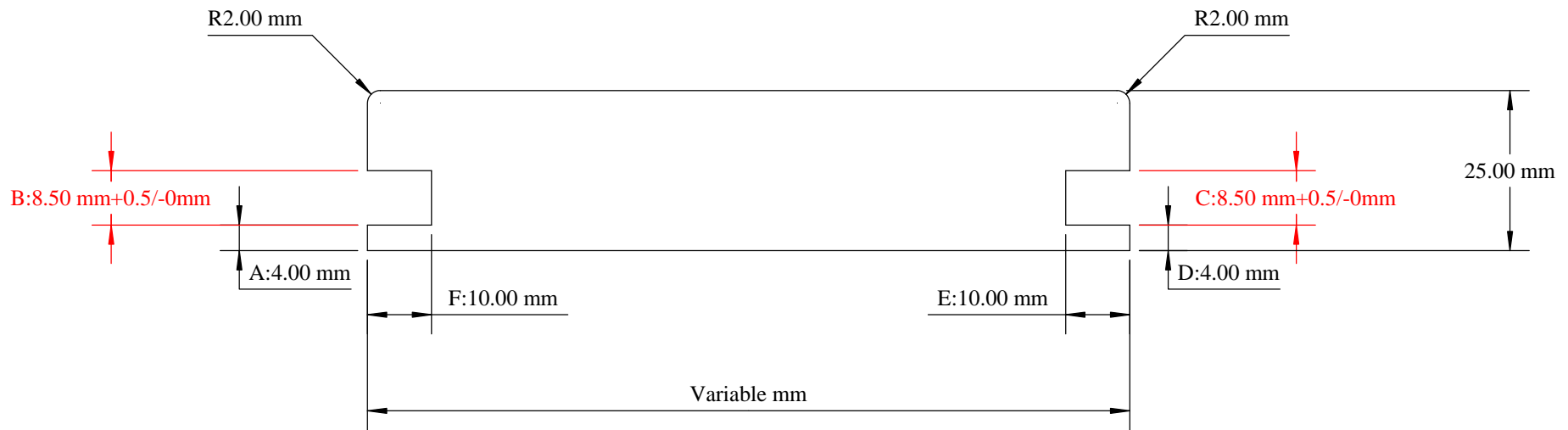

PRINTED COPY UNCONTROLLED

AREA MACHINED AWAY 171.72 SQMM.

MOULDER	4,6
PASSES	1
DRAWN BY	S McMaster
DATE	16/01/15
SCALE	1:1
REV:	1
AUTH:	
TOLERANCE	+/- 0.5MM

SAM MOULDINGS

Newpark Industrial Estate Greystone Road Antrim BT41 2RU
 Tel : (028) 9442 8288 Fax : (028) 9442 8244

Website: www.sammouldings.co.uk Email: info@sammouldings.co.uk

SAM 3603

PROFILE

DRAWN BY

S McMaster

REV: 1

DATE

16/01/15

AUTH:

SCALE

1:1

TOLERANCE
+/- 0.5MM