

Place SAM 01 profile block on side spindle 2.  
 Place SAM 01 profile block on side spindle 3.  
 Place 5mm PCD groover on the first top spindle. Set to produce 5.00x5.00mm groove.

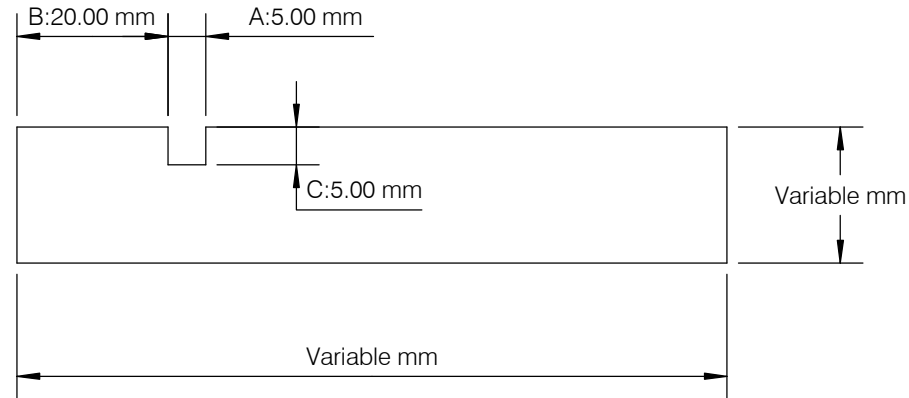

PRINTED COPY UNCONTROLLED

AREA MACHINED AWAY 25 SQMM.

MOULDER	ANY
PASSES	1
DRAWN BY	Bart Sobecki
REV:	3
DATE	10/02/2023
AUTH:	
SCALE	1:1
TOLERANCE	+/- 0.5MM

**SAM**<sup>®</sup>

Newpark Industrial Estate  
 Greystone Road, Antrim  
 BT41 2RU  
 T: +44 (0)28 9442 8288 F: +44 (0)28 9442 8244  
 E: team@samonline.co.uk  
 W: www.samonline.co.uk

PROFILE	DRAWN BY	Bart Sobecki	REV:	3
SAM 5059	DATE	10/02/2023	AUTH:	
	SCALE	1:1	TOLERANCE	+/- 0.5MM