

Place 45 DEGT2 profile block upside down on side spindle 3.  
 Place 45 DEGT1 profile block upside down on side spindle 3.  
 Place SAM 3031T1 profile block on the first top spindle.  
 Place SAM 3031T2 profile block on the second top spindle.

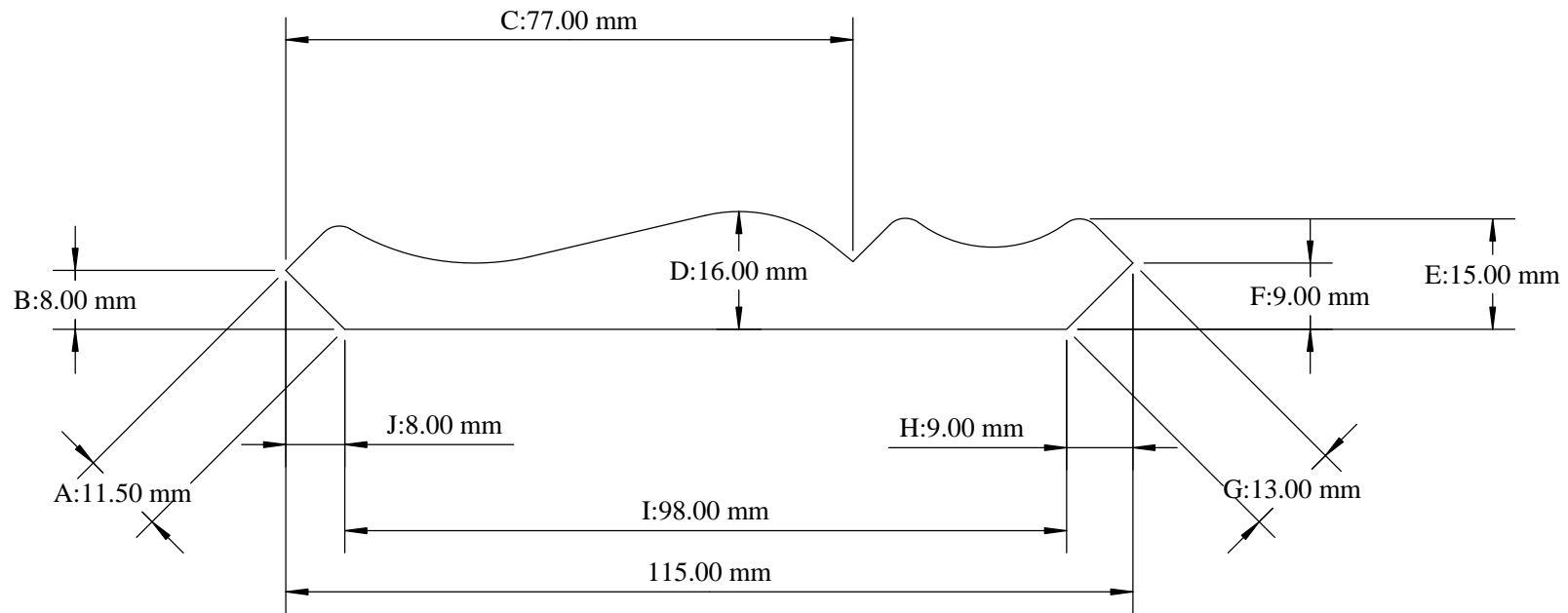

Check using test template, see page 2.

AREA MACHINED AWAY 495.16 SQMM.

MOULDER	3,4,5,6,7
PASSES	1
DRAWN BY	S McMaster
DATE	05/11/12
SCALE	1:1
REV:	1
AUTH:	
TOLERANCE	+/- 0.5MM

# SAM MOULDINGS

Newpark Industrial Estate Greystone Road Antrim BT41 2RU  
 Tel : (028) 9442 8288 Fax : (028) 9442 8244

Website: [www.sammouldings.co.uk](http://www.sammouldings.co.uk) Email: [info@sammouldings.co.uk](mailto:info@sammouldings.co.uk)

## SAM 3031

PRINTED COPY UNCONTROLLED

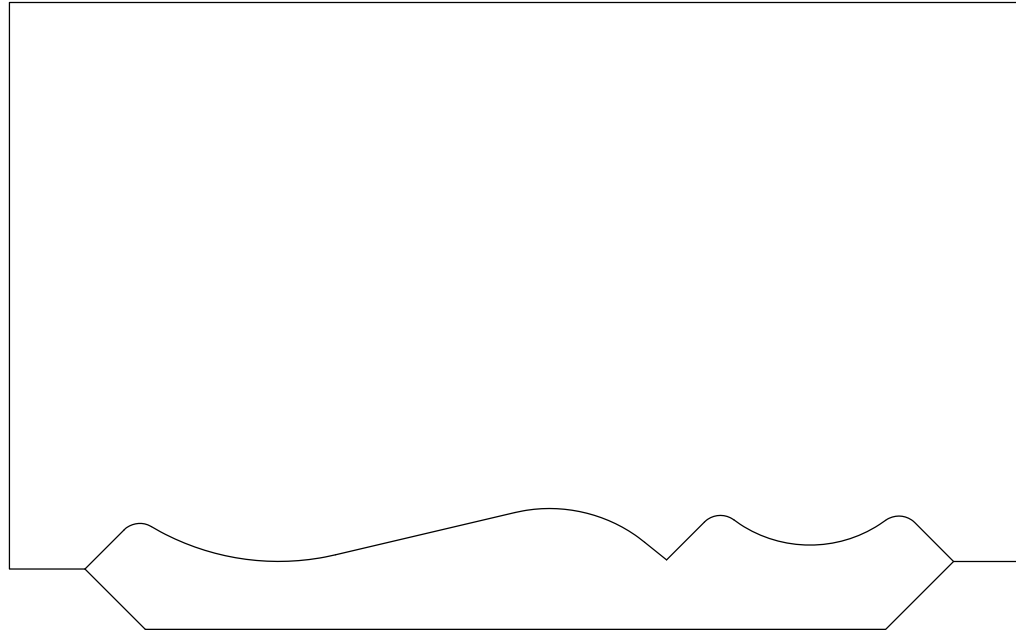

PRINTED COPY UNCONTROLLED

AREA MACHINED AWAY 495.16 SQMM.

MOULDER	3,4,5,6,7
PASSES	1
DRAWN BY	S McMaster
DATE	05/11/12
SCALE	1:1
REV:	1
AUTH:	
TOLERANCE	+/- 0.5MM

**SAM MOULDINGS**

Newpark Industrial Estate Greystone Road Antrim BT41 2RU  
 Tel : (028) 9442 8288 Fax : (028) 9442 8244  
 Website: [www.sammouldings.co.uk](http://www.sammouldings.co.uk) Email: [info@sammouldings.co.uk](mailto:info@sammouldings.co.uk)

PROFILE

**SAM 3031**

**TEST**