

Place SAM 01 profile block on side spindle 2.  
 Place SAM 01 profile block on side spindle 3.  
 Place 13-24mm adjustable diamond groover on the first top spindle set at 15.00mm. Set to produce 15.00 x 5.00mm deep groove.

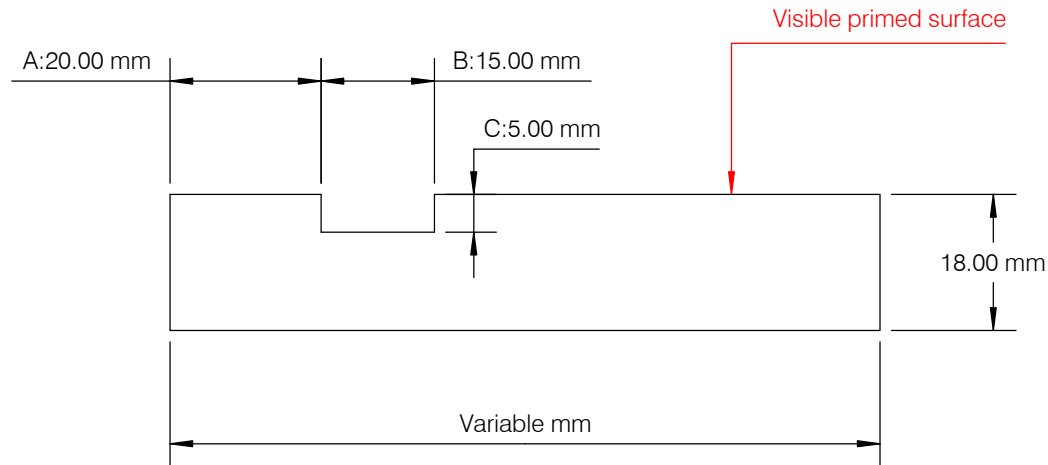

PRINTED COPY UNCONTROLLED

AREA MACHINED AWAY 75 SQMM.

MOULDER	ANY
PASSES	1
DRAWN BY	A McMaster
DATE	05/02/2019
SCALE	1:1
REV:	1
AUTH:	
TOLERANCE	+/- 0.5MM

**SAM**<sup>®</sup>

Newpark Industrial Estate  
 Greystone Road, Antrim  
 BT41 2RU  
 T: +44 (0)28 9442 8288 F: +44 (0)28 9442 8244  
 E: team@samonline.co.uk  
 W: www.samonline.co.uk

PROFILE  
**SAM 5060**