

Place SAM 01 profile block on side spindle 2.
 Place SAM 01 profile block on side spindle 3.
 Place Adjustable Groover on the first top spindle, to produce groove.

Please tick in box - Is groove a visible top surface for priming YES NO

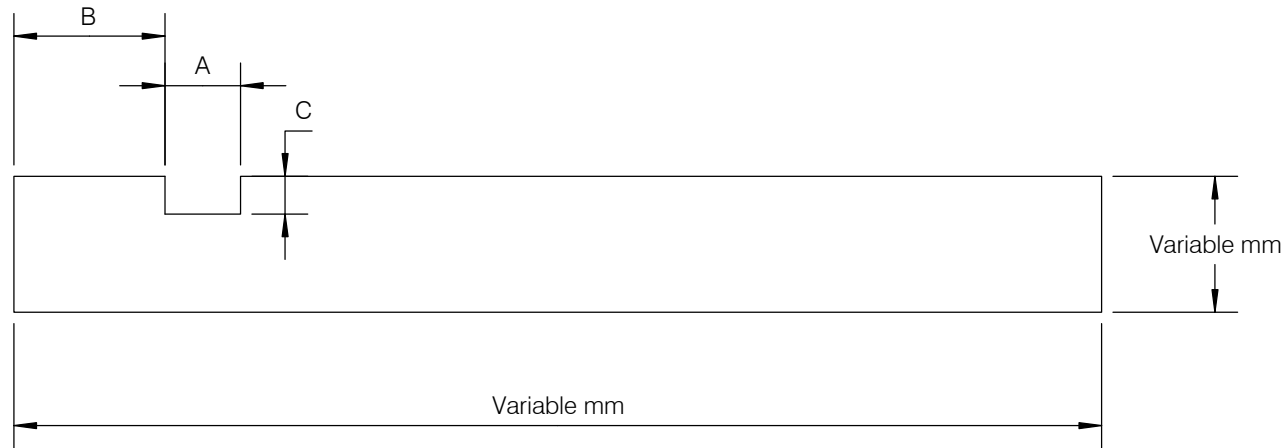

Please note: Max size for dim A is 62mm.

CUSTOMER TO CONFIRM DIMENSIONS A+B+C INCLUDING PRODUCT WIDTH AND THICKNESS

PRINTED COPY UNCONTROLLED

AREA MACHINED AWAY: Ax C SQMM



Newpark Industrial Estate
 Greystone Road, Antrim
 BT41 2RU
 T: +44 (0)28 9442 8288 F: +44 (0)28 9442 8244
 E: team@samonline.co.uk
 W: www.samonline.co.uk

			MOULDER	ANY
			PASSES	1
	PROFILE	DRAWN BY	S McMaster	REV: 1
	SP 600	DATE	18/06/2019	AUTH:
		SCALE	1:1	TOLERANCE +/- 0.5MM